

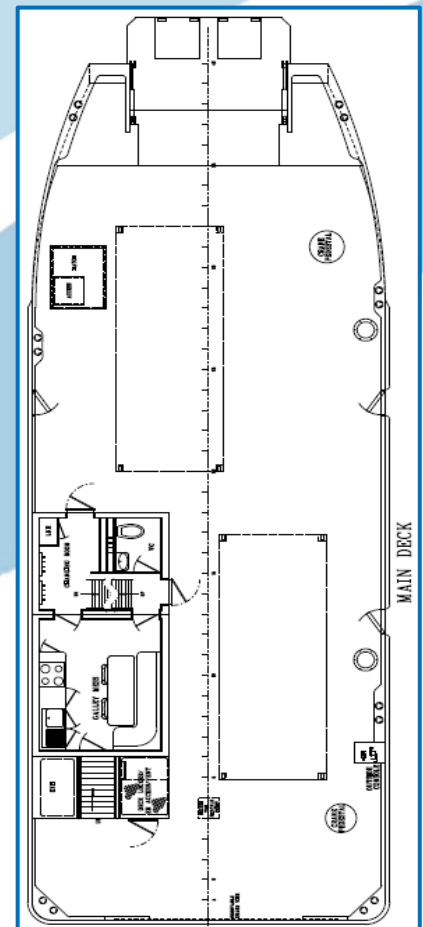

21m Fish Farm Service Vessel - MCA Cat 2 – 60 miles offshore

- general site service duties
- custom designed deck layout for mooring work
- capacity for 2 x ISO, net cleaning & towing
- bollard pull approx. 9 ton
- deck cargo 90 ton; capacity for 3 x 20 ft containers
- fuel and water transfer

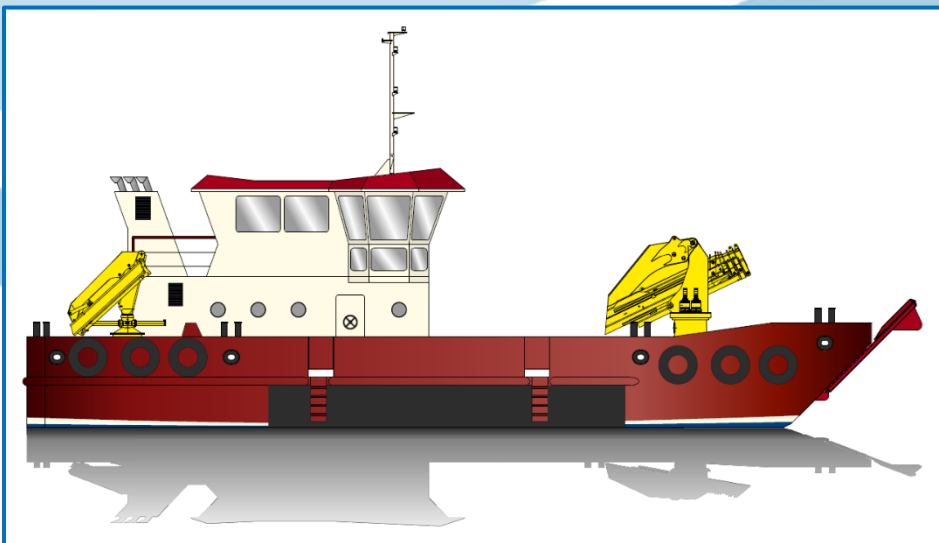

General:	Type of vessel	21m Fish Farm Service Vessel
	Class	MCA Cat 2 – 60 miles offshore
	Yard	Ferguson Marine Engineering, Glasgow
	Year of build	Delivery May 2019
<hr/>		
Dimensions:	LOA	21 m
	Beam	8.35 m
	Depth	2.5 m
	Draft (approx)	1.8 – 2.3 m
<hr/>		
Tank Capacities:	Fuel	14 m ³
	Fresh water	12 m ³
	Transfer pumps	6 m ³ /hr
	Ballast	40 m ³
<hr/>		
Performance:	Speed	9.5 kts (max)
	Bollard pull	9 ton (tbc)
<hr/>		
Propulsion System / Aux Equipment:	Main engines	2 x Doosan 4L126TI
	Total power	900 hp
	Propellers	Twin screw, fixed pitch props with high lift rudders
	Generator sets	1 x 120 kW (240-415V 3ph) and 1 x 20 kW
<hr/>		
Deck Layout	Deck crane fwd	61 ton/m; max outreach 19 m with remote
	Deck crane aft	13 ton/m; max outreach 11.5 m with remote
	Main winch	12 ton
	Anchor windlass	2 ton
	Capstan winch	3 x 5 ton
	Deck area/dimensions	136 m ² ; 19 m x 8.3 m
	Dry hold	30 m ³
	Deck cargo	86 ton
	Container capacity	3 x 20 ft & 1 x 10ft container
	Bow door	Hydraulic bow loading ramp
<hr/>		
Accommodation:	4 persons	Heated living space
	2 x 2 berth cabins	Shower/toilet
	Changing/drying area with toilet	
	Separate galley / mess room	