

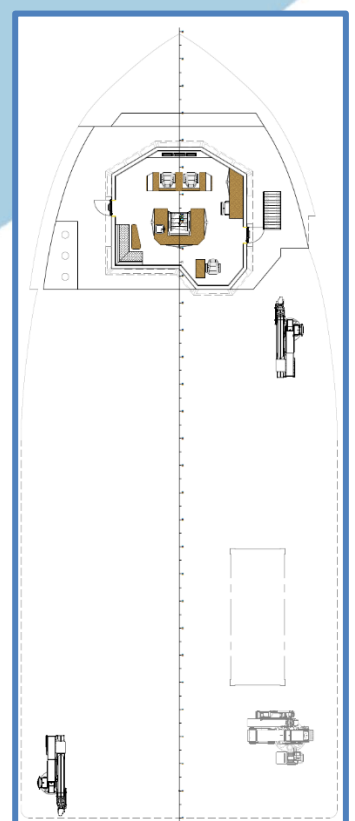

## 35 m Aquaculture Delicing Vessel – (DP-0)

- fitted with twin line Thermolicer with extended loop and heat recovery system
- 2 x Triple Stranda fish pump built into vessel
- 300 t/hr throughput capacity
- diesel electric power system with dynamic positioning (DP-0)
- capacity for 7 line Hydrolicer, Optilicer or SFI delicing units
- fuel and water transfer
- deck space 377 m<sup>2</sup>

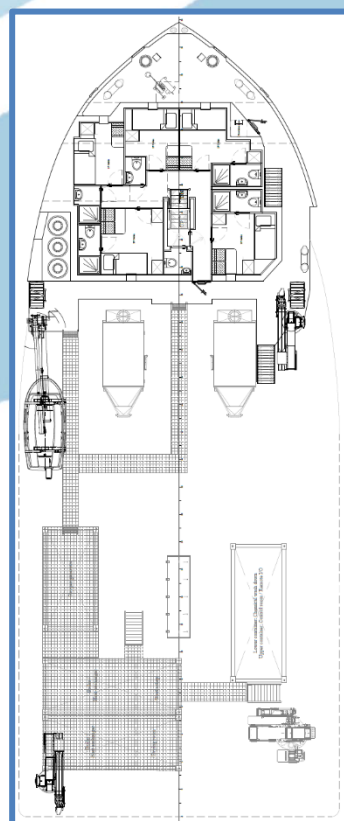
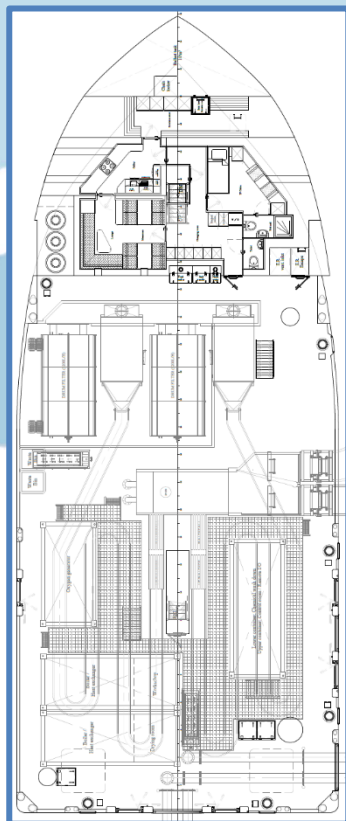
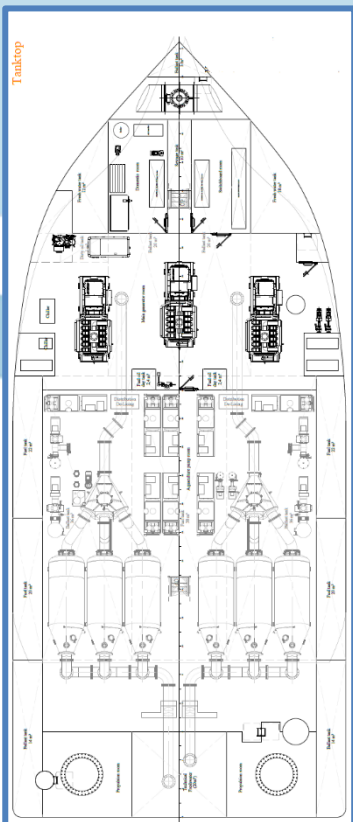

<b>General:</b>	<b>Type of vessel</b>	35 m Aquaculture Delicing Vessel
	<b>Class</b>	Lloyds Register (special craft); 150 miles +100 A1 SSC Workboat Mono G3 MCH DP(AM)
	<b>Yard</b>	Nauplius Workboats, Netherlands
	<b>Year of build</b>	Delivery June 2021
<b>Dimensions:</b>	<b>LOA</b>	35 m
	<b>Beam</b>	14.3 m
	<b>Depth</b>	3.5 m
	<b>Draft (approx)</b>	2.7 m
<b>Tank Capacities:</b>	<b>Fuel</b>	128 m <sup>3</sup>
	<b>Fresh water</b>	30 m <sup>3</sup>
	<b>Transfer pumps</b>	32 m <sup>3</sup> /hr
	<b>Ballast</b>	150 m <sup>3</sup>
<b>Performance:</b>	<b>Speed</b>	9 kts
	<b>Bollard pull</b>	15 ton (TBC)
<b>Propulsion System / Aux Equipment:</b>	<b>Main generator</b>	3 x Mitsubishi S12A2 (Z3) MPTA
	<b>Total power</b>	2850 hp
	<b>Main propulsion</b>	2 x VETH L-Drive, VL-400si (670 hp)
	<b>Bow thruster</b>	449 hp
	<b>Harbour set</b>	Volvo Penta D5A-T (94 hp)
<b>Deck Layout</b>	<b>Deck crane stbd aft</b>	HS AKC145 HE5 145 ton/m; max outreach 23.5 m with remote
	<b>Deck crane port aft</b>	HS AK48 E5+ 48 ton/m; max outreach 20 m with remote
	<b>Deck crane stbd fwd</b>	HS AK48 E5+ 48 ton/m; max outreach 20 m with remote
	<b>Capstans</b>	7 x 7 t
<b>Accommodation:</b>	9 persons	Heated living space
	3 x 2 berth cabins	3 x 1 berth cabin
	4 rooms en-suite	Shower/toilet
	Changing/drying area with toilet and laundry facility	
	Separate galley / messroom / lounge	
	Built in delicing control room	