

35 m Aquaculture Delicing Vessel – (DP-0)

- fitted with twin line Thermolicer with extended loop and heat recovery system
- 2 x Triple Stranda fish pump built into vessel
- 300 t/hr throughput capacity
- diesel electric power system with dynamic positioning (DP-0)
- capacity for 7 line Hydrolicer, Optilicer or SFI delicing units
- fuel and water transfer
- deck space 377 m²

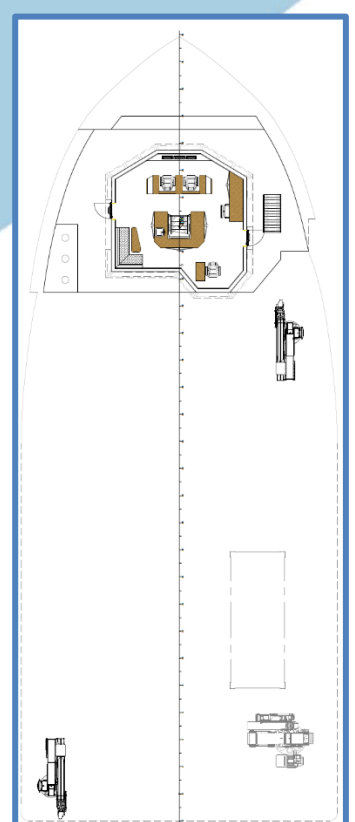
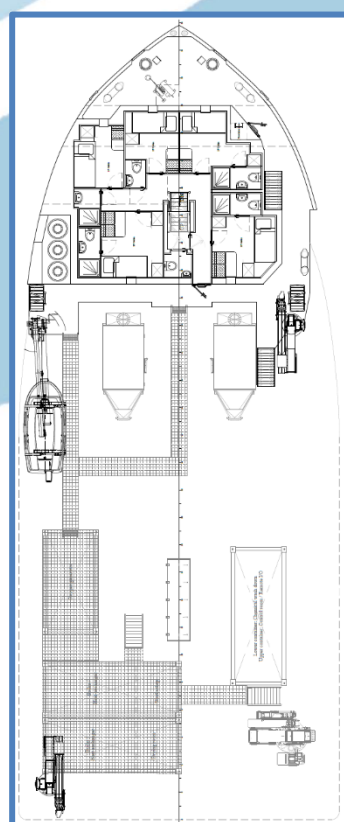
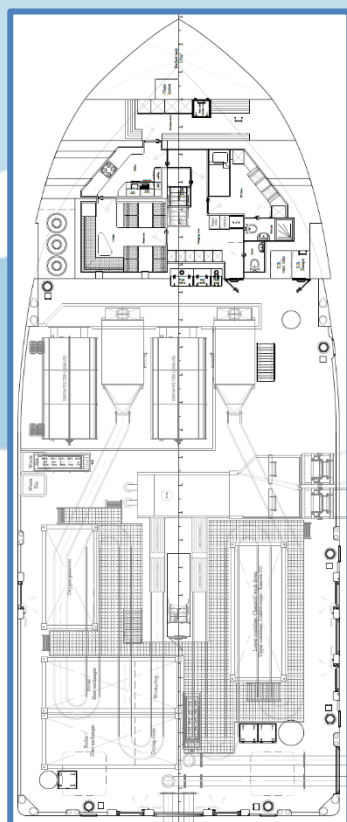
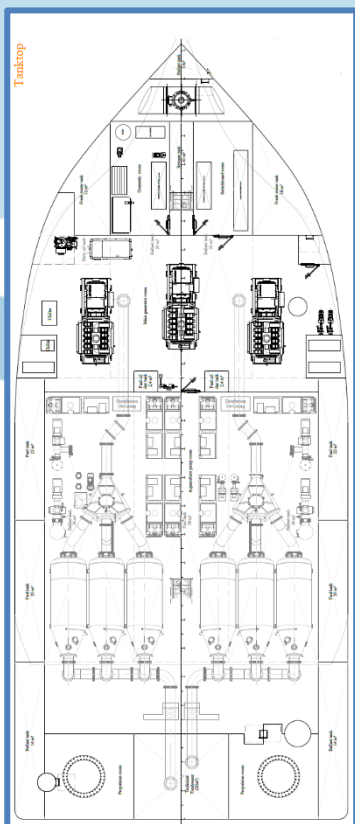

| | | |
|-------------------------------------------|-------------------------------------------------------|------------------------------------------------------------------------------------|
| General: | Type of vessel | 35 m Aquaculture Delicing Vessel |
| | Class | Lloyds Register (special craft); 150 miles +100 A1 SSC Workboat Mono G3 MCH DP(AM) |
| | Yard | Nauplius Workboats, Netherlands |
| | Year of build | Delivery June 2021 |
| Dimensions: | LOA | 35 m |
| | Beam | 14.3 m |
| | Depth | 3.5 m |
| | Draft (approx) | 2.7 m |
| Tank Capacities: | Fuel | 128 m ³ |
| | Fresh water | 30 m ³ |
| | Transfer pumps | 32 m ³ /hr |
| | Ballast | 150 m ³ |
| Performance: | Speed | 9 kts |
| | Bollard pull | 15 ton (TBC) |
| Propulsion System / Aux Equipment: | Main generator | 3 x Mitsubishi S12A2 (Z3) MPTA |
| | Total power | 2850 hp |
| | Main propulsion | 2 x VETH L-Drive, VL-400si (670 hp) |
| | Bow thruster | 449 hp |
| | Harbour set | Volvo Penta D5A-T (94 hp) |
| Deck Layout | Deck crane stbd aft | HS AKC145 HE5 145 ton/m; max outreach 23.5 m with remote |
| | Deck crane port aft | HS AK48 E5+ 48 ton/m; max outreach 20 m with remote |
| | Deck crane stbd fwd | HS AK48 E5+ 48 ton/m; max outreach 20 m with remote |
| | Capstans | 7 x 7 t |
| Accommodation: | 9 persons | Heated living space |
| | 3 x 2 berth cabins | 3 x 1 berth cabin |
| | 4 rooms en-suite | Shower/toilet |
| | Changing/drying area with toilet and laundry facility | |
| | Separate galley / messroom / lounge | |
| | Built in delicing control room | |