

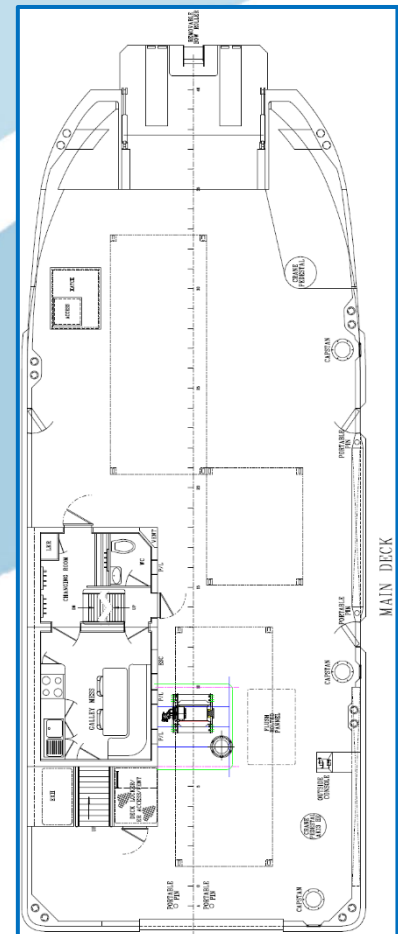

21m Fish Farm Service Vessel - MCA Cat 2 – 60 miles offshore

- general site service duties
- custom designed deck layout for mooring work
- capacity for 2 x ISO, net cleaning & towing
- bollard pull approx. 9 ton
- deck cargo 90 ton; capacity for 3 x 20 ft containers
- fuel and water transfer

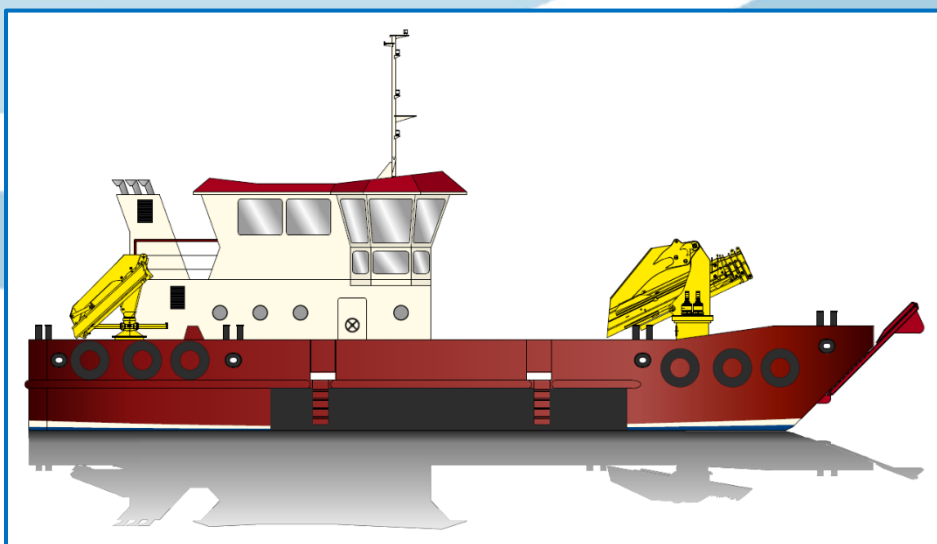

Helen Rice

Specifications

General:	Type of vessel Class Yard Year of build	21m Fish Farm Service Vessel MCA Cat 2 – 60 miles offshore Ferguson Marine Engineering, Glasgow Delivery August 2019
Dimensions:	LOA Beam Depth Draft (approx)	21 m 8.35 m 2.5 m 1.8 – 2.3 m
Tank Capacities:	Fuel Fresh water Transfer pumps Ballast	14 m ³ 12 m ³ 6 m ³ /hr 40 m ³
Performance:	Speed Bollard pull	9.5 kts (max) 9 ton (tbc)
Propulsion System / Aux Equipment:	Main engines Total power Propellers Generator sets	2 x Doosan 4L126TI 900 hp Twin screw, fixed pitch props with high lift rudders 1 x 120 kW (240-415V 3ph) and 1 x 20 kW
Deck Layout	Deck crane fwd Deck crane aft Main winch Anchor windlass Capstan winch Deck area/dimensions Dry hold Deck cargo Container capacity Bow door	61 ton/m; max outreach 19 m with remote 13 ton/m; max outreach 11.5 m with remote 12 ton 2 ton 3 x 5 ton 136 m ² ; 19 m x 8.3 m 30 m ³ 86 ton 3 x 20 ft & 1 x 10ft container Hydraulic bow loading ramp
Accommodation:	4 persons 2 x 2 berth cabins Changing/drying area with toilet Separate galley / mess room	Heated living space Shower/toilet